

Measuring insert W2, W4, W5

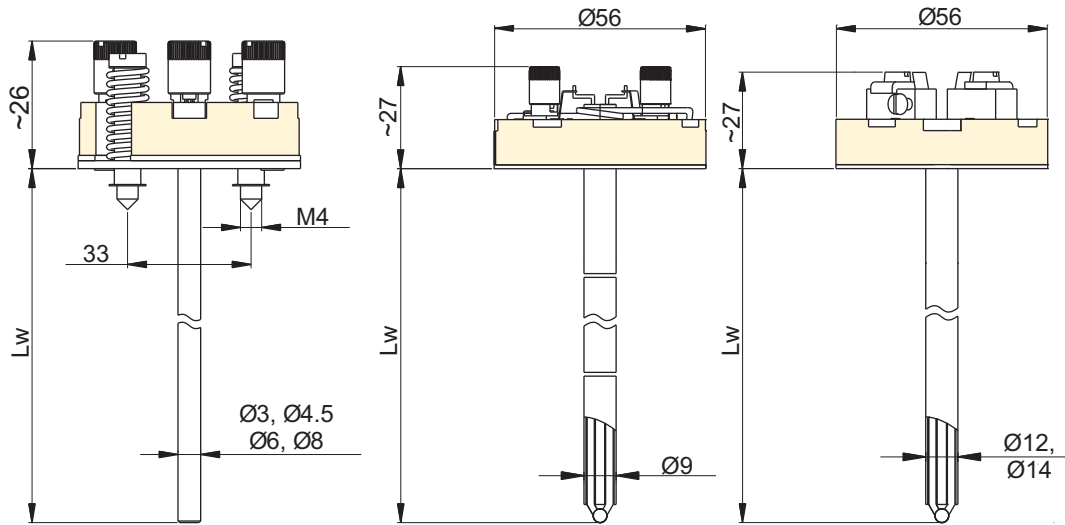

Measuring range of insert

Ordering procedure

with example of ordering code:

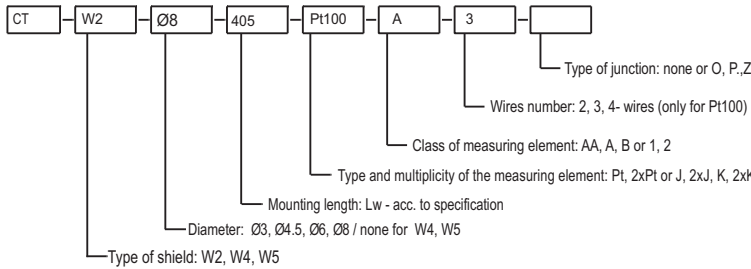

	Insert type		
	W2	W4	W5
Pt	-70÷500°C/-196÷150°C**		
J	-40÷550°C		
K	-40÷550°C/-40÷1000°C	-40÷1000°C (1100°C)*	-40÷1000°C (1150°C)*
S		0÷1300°C (1600°C)*	
B		600÷1600°C (1800°C)*	
Shield	316/Inconel	Ceramic	Ceramic

* - value in the bracket is the maximum admissible momentary temperature
 ** - low temperature version

CLAMPING GRIPS APPLIED FOR MOUNTING THE TEMPERATURE SENSORS

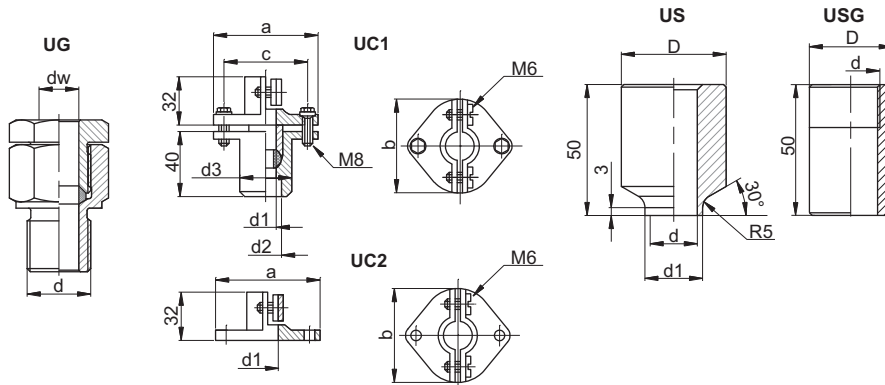

Type	Marking	Eksternal diameter of sensor's shield [mm]	Dimensions [mm]													Material
			dw	s	l	d	k	a	b	c	d1	d2	d3	D		
UG	UG6	6	6.5	22	16	M16x1.5	28									316ss
	UG8	8	8.5	22	16	M16x1.5	28									
	UG15	15	15.5	32	20	M24x2	32									
UC1	UC1-15	15						75	50	55	16	26	35		St30	
	UC1-22	22						90	65	70	23	33	40			
UC2	UC2-15	15						75	50	55	16			St30		
	UC2-22	22						90	65	70	23					
US	US18					Ø18H7					22			40	316ss 15HM 10H2M	
	US24					Ø24H7					30			50		
USG	USG-M20x1.5 USG-G1/2" USG-1/2"NPT					M20x1.5 G1/2" 1/2"NPT								30	316ss 15HM	

Admissible load: UG - 8MPa, UC1 - 0,1MPa

Ordering procedure with example of ordering code:

